

Fellowship Primitive Baptist Church
2162 Fellowship Road
Tucker, DeKalb County, Georgia

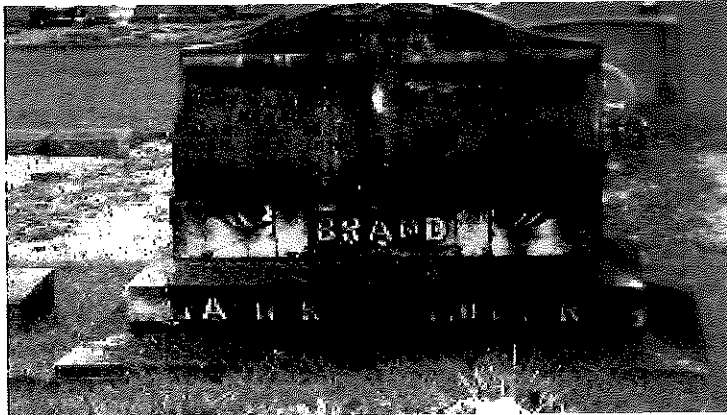

Jonas Washington Brand Plot



Jonas Washington and Elizabeth Ann Gatewood Shumate Brand



Lillie Brand
Daughter of Jonas and Elizabeth



Sarah Ardella Brand Summerlin
Daughter of Jonas and Elizabeth



Lura E. Brand
Daughter of Jonas and Elizabeth

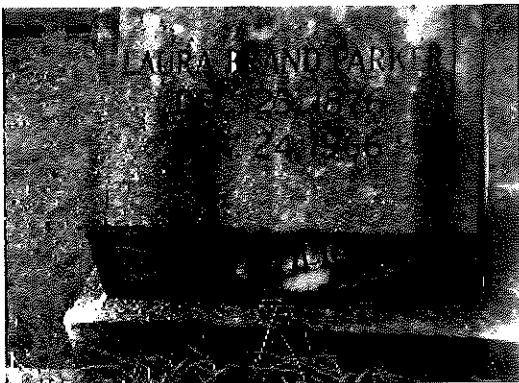

Laura Brand Parker. Daughter of Jonas and Elizabeth

FELLOWSHIP PRIMITIVE BAPTIST CHURCHYARD.

Location: Fellowship Road between Lawrenceville Rd. and
Charlie Morris Rd., near Tucker, Ga.
18th District, DeKalb County, Brownings' District.

Recorded June 9, 1931.

Wife	Lillie	May 21, 1900 - Sept. 26, 1918. Dau. of W. L. & S. A. Ball.
Wife	Elizabeth A. G.	Aug. 15, 1846 - Oct. 17, 1912. Wife of Jonas W. Broad.
Wife	Jonas Washington.	March 14, 1836 - March 23, 1916.
Wife	Louise Jordan.	Sept. 5, 1850 - Aug. 30, 1895. Wife of N. J. Britt.
Wife	N. J.	June 17, 1838 - Feb. 11, 1916.
Wife	Oris Laurence.	Feb. 2, 1916 - Nov. 16, 1927. Son of Mr. & Mrs. J. G. Britt.
Wife	Wiley T.	July 1, 1866 - Aug. 22, 1901.
Wife	Mamie V.	Dec. 15, 1869 - Aug. 24, 1890. Wife of J. H. Brooks.
Wife	T. R.	Dec. 26, 1825 - Sept. 27, 1890.
Wife	Emily Kite, Mrs.	May 30, 1832 - Dec. 4, 1914. Dau. of Mr. & Mrs. G. T. Hopkins.
Wife	Earnest B.	Mar. 2, 1831 - Sept. 24, 1894.
Wife	Willard V.	May 23, 1856 - Oct. 2, 1921.
Wife	Charles L.	June 26, 1867 - Nov. 4, 1911. Husband of Janie Chewning.
Wife	D. P.	Feb. 1, 1861 - March 31, 1917.
Wife	Eliza E.	Nov. 24, 1840 - Jan. 10, 1912. Wife of Richmond A. Chewning.
Wife	Hattie H.	Sept. 3, 1867 - Wife of D. P. Chewning.
Wife	Richmond B.	Feb. 24, 1838 - Jan. 22, 1907.
Wife	W. J. G.	May 20, 1850 - Dec. 12, 1915. Wife of James T. Dickens.

Fellowship Primitive Baptist Churchyard. (cont.)

Dickens,	James T.	June 12, 1846 - April 20, 1908.
Dickerson,	Nancy A.	July 3, 1845 - Sept. 25, 1923. Wife of Thos. W. Dickerson.
Dickerson,	Thomas W.	Aug. 12, 1843 - Sept. 14, 1920.
England,	George M.	May 31, 1854 - Jan. 25, 1927.
England,	Jerusha, Miss.	March 25, 1863 - Dec. 21, 1905.
England,	Junius M.	March 9, 1882 - June 23, 1925.
England,	Laura C.	Jan. 5, 1858 - June 7, 1874. Wife of Geo. M. England.
England,	Martha J.	May 25, 1830 - March 17, 1891.
England,	Robert A.	May 13, 1818 - Jan. 17, 1899.
England,	Verda.	July 16, 1887 - Sept. 24, 1912. Wife of Junius M. England.
Estes,	F. Clark.	Feb. 21, 1901 - Aug. 17, 1922.
Estes,	Hettie E.	March 15, 1871 ——— Wife of Jabez C. Estes.
Estes,	Jabez C.	March 27, 1870 ——— Died Dec. 13, 1892. Birth Unknown.
Haynie,	J. F.	April 25, 1830 - Feb. 9, 1925.
Hazlerig,	Luther G.	July 28, 1907 - Oct. 12, 1918.
Hazlerig,	Ruby May.	Dec. 18, 1835 - Oct. 7, 1897.
Hazlerigs,	Benjamin F.	Aug. 18, 1887 - Jan. 30, 1905.
Hazlerigs,	Minnie V.	Feb. 22, 1880 - March 7, 1902.
Hazlerigs,	Samuel S.	April 10, 1838 - Aug. 23, 1902.
Hopkins,	Green Thomas.	April 3, 1875 - July 10, 1897.
Hopkins,	Lona.	Sept. 26, 1842 - May 23, 1920. Wife of Green T. Hopkins.
Hopkins,	Margaret H. Mrs.	March 6, 1823 - Aug. 20, 1887. Capt. Co. F. 36 Reg. Ga. Vol.
Hudson,	George B.	Feb. 24, 1861 - Dec. 31, 1907. Wife of F. R. Hudson. (B).
Hudson,	Loudovia.	Oct. 28, 1867 - March 25, 1880. Wife of F. R. Hudson. (D).
Hudson,	Sarah A.	

Fellowship Primitive Baptist Churchyard. (cont)

son,	Sarah E.	Oct. 18, 1869 - April 10, 1889 Daughter of G.B. & S.E. Hudson.
son,	Sarah E. McDaniel	July 13, 1829 - Feb. 19, 1910. Wife of George B. Hudson.
son,	M.E. Mrs.	Nov. 23, 1835 - June 30, 1904.
son,	Milton.	No inscribed marker. (Statement of Mrs. Henderson, old resident of the section)
son,	Richard S.	Jan. 20, 1917 - Jan. 14, 1927.
son,	Joseph H.	Oct. 29, 1854 - March 3, 1921.
son,	F.M.	Aug. 12, 1827 - May 24, 1920.
son,	Georgia.	Oct. 19, 1852 - May 13, 1909.
son,	J.H.	Feb. 28, 1825 - June 23, 1907.
son,	Martha K.	July 1, 1818 - Feb. 15, 1891 Wife of J.H. Kimbrell.
Koetz	Julia.	July 20, 1854 - Dec. 4, 1916. Wife of John Koetz.
Koetz	Anna Pale. (Ball) ¹²	June 19, 1895 - Aug. 21, 1916. Wife of J.H. Koetz.
L	Beatrice.	Dec. 8, 1903 - April 10, 1915. Daughter of E.F. & F.B. Lawhorn.
Lietch	S.H.	Feb. 18, 1824 - June 22, 1901.
Lietch	Susan.	Nov. 9, 1855 - Nov. 10, 1926.
M	Dana.	April 9, 1875 - Feb. 21, 1910. Wife of T.R. Massey. (2)
M	Emily A.	Jan. 12, 1865 - June 15, 1903. Wife of T.R. Massey. (1)
M	Annah L.	April 8, 1851 - June 12, 1907. Wife of Geo. W. Mitchell.
M	George Washington.	July 22, 1839 - June 30, 1895.
Morris	Lyathia E.	1839 - 1925. Wife of Wm. H. Morris.
Morris	William H.	1841 - 1920.
Nash	Mary A. Parker	Oct. 28, 1830 - April 16, 1916. Wife of Luckin Nash.

Fellowship Primitive Baptist Churchyard. (cont'd).

Quinn,	Eda Webb.	March 20, 1880 - Oct. 13, 1903. Daughter of J.W. Webb.
Shaw,	Tilla.	Nov. 16, 1879 - Feb. 13, 1910.
Simplexian,	Minnie R.	Died March 15, 1911. Aged 37 yrs. Wife of B.C. Simplexian.
Stanley,	Malissa A.	July 12, 1850 - Nov. 17, 1903.
Talbot,	M.B. Dr.	1841 - Dec. 2, 1925.
Taylor,	Mary L.	Dec. 12, 1828 - Nov. 11, 1869. Daughter of Mr. & Mrs. F.C. Taylor.
Turner,	Lewis Goodman.	Jan. 7, 1878 - June 6, 1901.
Warren,	J.E.B.	Dec. 29, 1856 - Sept. 20, 1921.
Warren,	Rebecca C.	Dec. 10, 1819 - Jan. 7, 1905.
Warren,	Sarah Louella.	Sept. 25, 1834 - Jan. 2, 1913. Wife of R.O. Warren.
Webb,	J.W.	March 31, 1849 - Nov. 7, 1926.
Webbhook,	Mary J.	Sept. 21, 1848 - Jan. 9, 1883.
Whitfield,	Lenora.	March 29, 1877 - Oct. 2, 1907. Wife of C.E. Whitfield, M.D. Daughter of G.M. & L.C. England.
Wright,	Davis F.	July 21, 1863 - July 10, 1889.
Wright,	Lucy.	Died 1889. Age about 20 yrs. Wife of Wm. Wright.
Wright,	Mary.	No Dates.
Wright,	Savilla.	No Dates.
Wright,	Aunt Susan.	No Dates.

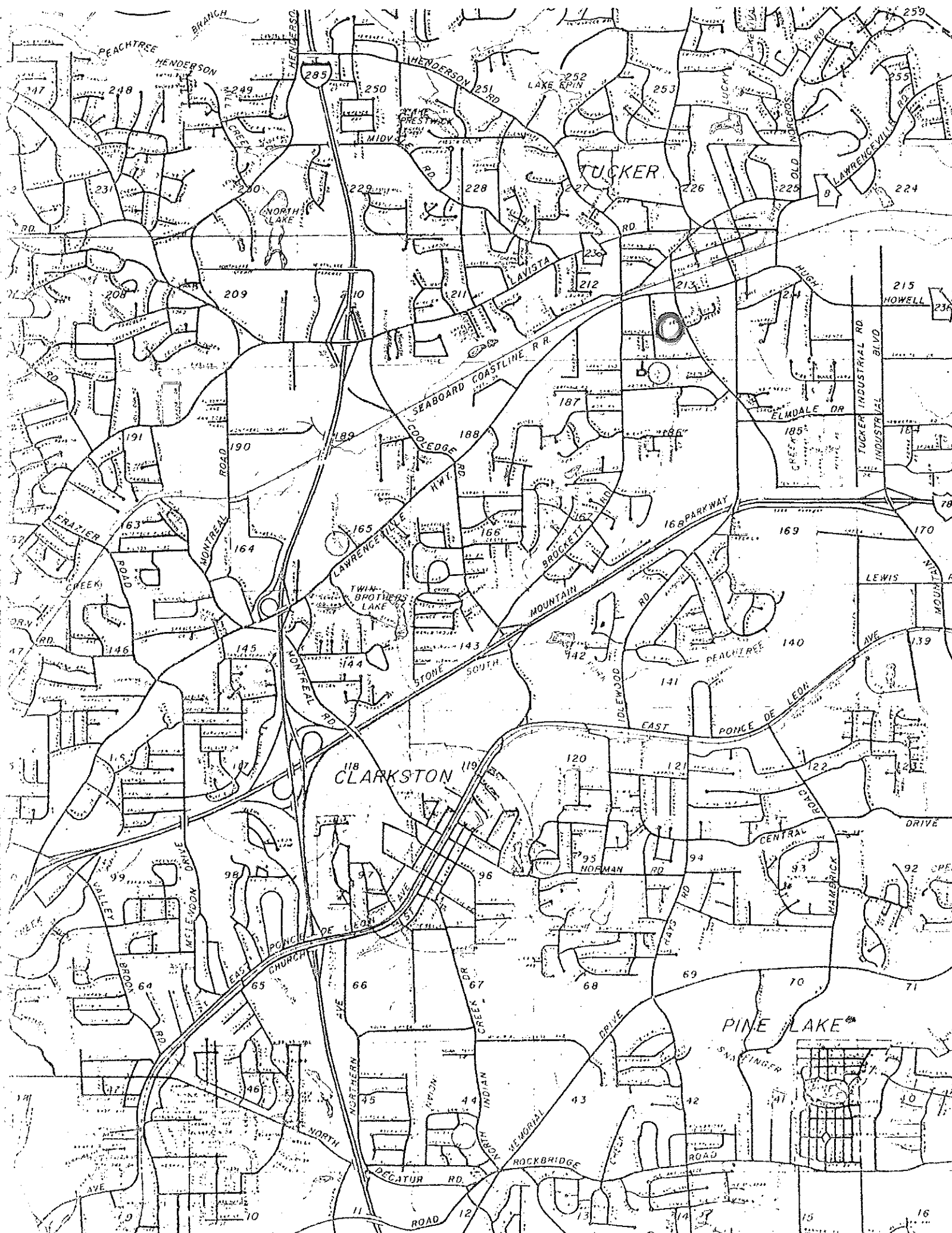

27 December 1994
2055 Foster Drive
Cumming, GA 30130

Fellowship Primitive Baptist Church
c/o Pastor J.M. Hunt, Jr.
2162 Fellowship Rd.
Tucker, GA 30084

Dear Pastor Hunt;

I've just completed a survey of the cemetery at your Church location and have enclosed a copy of my field notes for your use.

I grew up in Tucker in the 1950s & 60s, graduated from Tucker High School in 1961 and was next-door neighbors to Troy & Velma Adams who are buried there. I know that this cemetery has never been surveyed or published and am interested in preserving the grave marker records of all these early settlers of Tucker.

I hope there is a person in the Church who could work on this to add names of some of those buried in the "U" (Unmarked) graves. Perhaps there is a "Cemetery Committee" or other group within the Church who care for such things?

For example, on page 17 are 3 "U" markers which have flowers there when I made the survey, so I'm certain someone knows who these are buried here. Others in the Church may know the identity of some of the other "U" markers, as well.

On page 41 you will note there is one marker lying in the woods which has been somehow removed from it's proper location. Does someone know where it should be?

I would appreciate someone sending me copies of any corrected pages they may be able to make. If someone there has a computer, it would be very helpful for you folks to alphabetize all these names to make it easy to identify those buried there.

I hope you will find this helpful. It is obvious that this cemetery has been well cared for over the years; it is my pleasure to provide this.

Sincerely,

Ted Brooke

January 14, 1995

Dear Carolyn,

Enclosed is a copy of a recent cemetery survey done by Ted Brooke. It concerns the Fellowship Primitive Baptist Church on Fellowship Road, Tucker, Georgia. As far as he could determine, Mr. Barrett had not surveyed this cemetery.

This is not the same cemetery as the Old Fellowship Primitive Baptist Church Cemetery between Wildwood Lane and Pine Valley Road.

I believe this will be a useful addition to the file of cemetery records at DeKalb Historical Society's archives. On behalf of Ted Brooke and myself, thank you for accepting this record.

Sincerely,

Delia Dilliland

- CEMETERY SURVEY TITLE SHEET -
DEKALB County, GA

Cemetery FELLOWSHIP PRIMITIVE BAPTIST CHURCH Page 1 / 43

Location: (In NE area of DEKALB Co, GA).

FROM U.S. HWY 29 IN TUCKER, GO SOUTH ON FELLOWSHIP RD.
1/10 MI TO CHURCH & CEMETERY SITE ON RIGHT (WEST)
SIDE OF ROAD.

First Surveyor TED BROOKE Date 12/1/1994
 (use dark ink)

Address 2055 FOSTER DR, CUMMING, GA 30130 Phone # (404) 781-9221

Second Surveyor _____ Date / /
 (use red ink)

Address _____ Phone # _____

Note Codes <PRINT ALL INFORMATION> Map of location

- U = Unmarked grave
- UM = Uninscribed marker/rock
- FH = Funeral Home marker
- F = Foot Marker
- D = Double marker
- T = Triple marker
- = Missing information

All cemeteries are surveyed by rows, in left to right order. Specify the corner where survey is begun (NE, NW, SE, SW).

All family plots should be bracketed ([]) at the left of the Note column.

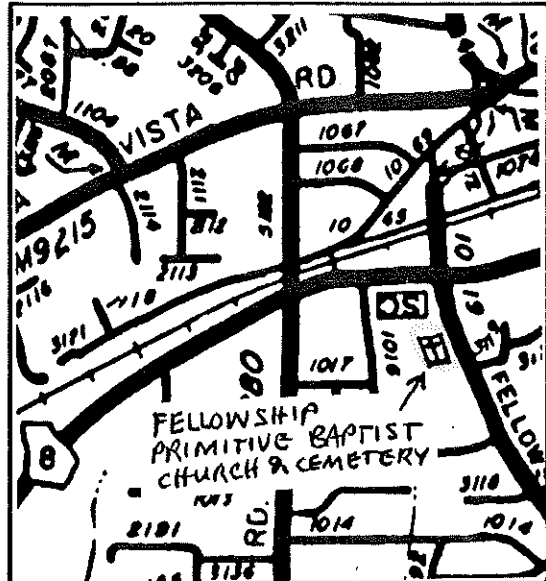

If a grave is unmarked but identified by another person, enter "U" in the Note Code & show the information in ()'s. List name of the person who provides that information.

NOTES SIGN AT CHURCH (DEC 1994): FELLOWSHIP PRIMITIVE BAPTIST

CHURCH EST. 1829. PASTOR-ELD. J.M. HUNT, JR.

(ADDRESS: 2162 FELLOWSHIP RD., TUCKER, GA

- CEMETERY SURVEY SHEET -
DEKALB County, GA

(BEGAN IN SE CORNER)

Cemetery FELLOWSHIP PRIMITIVE BAPTIST CHURCH Page 2 / 43

Surveyor TED BROOKE, CUMMING, GA. Date 12/01/94

Note	Last	First	Middle	B- dy	M- mo	Y- year	Other Information
D	CAIN	MARION A.		B-1876			F = "FATHER"
				D-1947			
D	CAIN	ELLA M.		B-1887			F = "MOTHER"
				D-1958			
D	BROWN	JAMES W.		B-23 JUL 1874			
				D-6 OCT 1947			
D	BROWN	EFFIE P.		B-7 MAR 1877			
				D-27 FEB 1948			
	BROWN	R. EUGENE		B-3 OCT 1906			
				D-14 MAY 1912			
	ANDREWS	WM. WALTER		B-21 OCT 1868			"M.D."
				D-18 JUL 1942			
	ANDREWS	BESSIE TIMMS		B-24 MAY 1889			
				D-1 SEP 1977			
	ANDREWS	INF. D.M.A.		B-27 JUL 1914			INFANT DAU. OF DR. & MRS. WM. W. ANDREWS
				D-29 JAN 1915			
	NASH	MEDWYL		B-			INFANT OF B.E. & ISLA NASH
				D-1911			
	WARREN	RALPH BRITT		B-3 DEC 1912			SON OF R.O. & S.L. WARREN
				D-6 MAR 1913			
	WARREN	SARA LOUELLA		B-25 SEP 1884			WIFE OF R.O. WARREN
				D-2 JAN 1913			F - "S.L.W."
	WARREN	ROBERT O.		B-8 APR 1880			F. - "R.O.W."
				D-15 JUN 1938			
	BRITT	WILLIE		B-21 MAR 1912			SON OF F.M. & T.N. BRITT
				D-17 FEB 1918			

Notes: _____

Ted O. Brooke
 2055 Foster Drive
 Cumming, GA 30130

- CEMETERY SURVEY SHEET -
DEKALB County, GA

Cemetery FELLOWSHIP PRIMITIVE BAPTIST CHURCH Page 3/43

Surveyor TED BROUKE, CUMMING, GA. Date 12/01/94

Note	Last	First	Middle	B	D	Other Information
D	BRITT	FRANK	M.	10 JUN 1880	21 SEP 1952	"FATHER"
D	BRITT	LULA	N.	26 MAR 1908	16 SEP 1956	"MOTHER"
D	BRITT	J.	W.	4 MAY 1859	31 DEC 1932	
D	BRITT	M.	J.	21 SEP 1859	4 JAN 1948	
	WILLIAMS	CLARA	BRITT	25 JUN 1889	29 AUG 1956	
	JOHNSON	RICHARD	S.	20 JAN 1917	14 JAN 1927	(ART - SEE PHOTO)
	JOHNSON	LULAR	THOMAS	8 AUG 1894	28 NOV 1983	
	THOMAS	BARBARA		25 NOV 1892	4 OCT 1977	
D	THOMAS	ROBERT	L.	5 OCT 1859	10 MAR 1931	
D	THOMAS	DORA	D.	30 DEC 1862	14 JUN 1937	
				B-	D-	
				B-	D-	
				B-	D-	
				B-	D-	

Notes: _____

Ted U. Brouke
 2055 Foster Drive
 Cumming, GA 30130

- CEMETERY SURVEY SHEET -
DEKALB County, GA

Cemetery FELLOWSHIP PRIMITIVE BAPTIST CHURCH Page 4 / 43

Surveyor TED BROOKE, CUMMING, GA.

Date 12/01/94

Note	Last	First	Middle	- Name -	- Dates -	Other Information
					dy/mo/year	
	COWN	CONSTANCE	JANE		B-23 MAR 1926 / D-20 APR 1926	
	DAVIS	INFANT	DAU.		B- - / D-1 APR 1958	INFANT DAU. OF MR. & MRS. D. J. DAVIS
	DAVIS	WAYNE	THOMAS		B-22 APR 1961 / D-25 APR 1961	
D	DAVIS	DOUGLAS	J.		B-20 FEB 1935 / D- -	"FATHER"
D	DAVIS	HELEN	PATSY		B-18 JUL 1938 / D-13 MAR 1971	"MOTHER"
D	HUNT	MACON	H.		B-25 APR 1902 / D-15 APR 1964	"ELDER"
D	HUNT	FRANCES	G.		B-8 NOV 1901 / D-1 JUN 1982	
— (END OF ROW 1 - START OF ROW 2) —						
	BRITT	WILLIAM	NELSON		B-30 OCT 1886 / D-16 APR 1982	
	BRITT	JAMES	W.		B-25 MAY 1914 / D-13 JUL 1950	GEORGIA - S SGT 629 MEDICAL CLR CO. WORLD WAR II
	BRITT	MARY	RUTH		B-6 MAY 1917 / D-17 JAN 1923	(ART: PRAYING ANGEL - SEE PHOTO)
	BRITT	LEILA	FORD		B-19 JUL 1894 / D-11 FEB 1939	
	BRITT	LOUELL			B-1 OCT 1917 / D-9 APR 1921	"LITTLE LOUELL, SON OF MR. & MRS. J. L. BRITT

Notes: _____

Ted O. Brooke
 2055 Foster Drive
 Cumming, GA 30130

- CEMETERY SURVEY SHEET -
DEKALB County, GA

Cemetery FELLOWSHIP PRIMITIVE BAPTIST CHURCH Page 5, 43

Surveyor TED BROOKE, CUMMING, GA. Date 12/01/94

Note	Last	First	Middle	dy	mo	year	Other Information
	ROBERTSON,	ARTHUR	JOSEPH	B-21	JUL	1900	SSGT, US ARMY, WORLD WAR II
				D-4	JUL	1976	
U				B-			
				D-			
	BRITT,	CHARLIE	N.	B-12	NOV	1862	
				D-7	APR	1943	
	BRITT,	SARAH	IANTHIE	B-20	JAN	1863	
				D-3	APR	1933	
	ENGLAND,	VERDA		B-16	JUL	1887	WIFE OF J. M. ENGLAND
				D-24	SEP	1912	F. = "V.E."
	ENGLAND,	JUNIUS	M.	B-9	MAR	1882	F. = "J.M.E."
				D-23	JUN	1925	
D	ENGLAND,	CARRIE	C.	B-16	MAR	1907	F = "H.C.E"
				D-19	SEP	1988	
D	ENGLAND,	HOWARD	C.	B-22	MUG	1904	F. = "C.C.E"
				D-1	NOV	1964	
	ENGLAND,	RAY	JUNIUS	B-28	MAY	1927	F. = "R.J.E"
				D-28	SEP	1989	
	BRITT,	OTIS	LAWRENCE	B-2	FEB	1916	
				D-16	NOV	1927	
D	BRITT,	JOHN	G.	B-17	SEP	1886	
				D-27	APR	1955	
D	BRITT,	CLARA	RICE	B-11	SEP	1889	
				D-28	NOV	1967	
				B-			
				D-			

Notes: _____

Ted O. Brooke
 2055 Foster Drive
 Cumming, GA 30130

- CEMETERY SURVEY SHEET -
DEKALB County, GA

Cemetery FELLOWSHIP PRIMITIVE BAPTIST CHURCH Page 6 / 43

Surveyor TED BROOKE, CUMMING, GA, Date 12/01/94

Note	Last	First	Middle	B- dy/mo/year	D- dy/mo/year	Other Information
------	------	-------	--------	------------------	------------------	-------------------

D	CALDWELL	WILBUR	M.	B-23 JUN 1912	D-30 OCT 1960	
---	----------	--------	----	---------------	---------------	--

D	CALDWELL	HENRIETTA	B.	B-11 MAY 1918	D-30 JUL 1989	
---	----------	-----------	----	---------------	---------------	--

	THOMAS		INFANT DAU.	B-	D-19 FEB 1923	
--	--------	--	-------------	----	---------------	--

D	THOMAS		FOSTER	B-26 JUN 1881	D-24 JAN 1962	
---	--------	--	--------	---------------	---------------	--

D	THOMAS	LILLIE	J.	B-3 DEC 1889	D-28 NOV 1970	
---	--------	--------	----	--------------	---------------	--

	ROGERS	SARA	THOMAS	B-4 APR 1916	D-24 SEP 1989	
--	--------	------	--------	--------------	---------------	--

D	WARREN	CAROLYN	THOMAS	B-19 NOV 1913	D-30 JUN 1994	
---	--------	---------	--------	---------------	---------------	--

D	WARREN	N.E.	"GENE"	B-4 JUL 1910	D-10 OCT 1985	
---	--------	------	--------	--------------	---------------	--

	MAIJALA	WAINO	AUREA	B-11 SEP 1905	D-21 AUG 1979	
--	---------	-------	-------	---------------	---------------	--

D	ADAMS	TROY	H.	B-30 OCT 1892	D-2 AUG 1964	F. = "FATHER"
---	-------	------	----	---------------	--------------	---------------

D	ADAMS	VELMA	E.	B-8 AUG 1891	D-1 APR 1964	F. = "MOTHER"
---	-------	-------	----	--------------	--------------	---------------

U				B-	D-	(PLOT, NO MKRS)
---	--	--	--	----	----	-----------------

D	HUDSON	HILDA		B-1924	D-1930	"LITTLE HILDA"
---	--------	-------	--	--------	--------	----------------

D	HUDSON	MORRIS		B-1929	D-1930	"BABY MORRIS"
---	--------	--------	--	--------	--------	---------------

Notes:

— (END OF ROW 2) —

Ted U. Brooke
 2055 Foster Drive
 Cumming, GA 30130

- CEMETERY SURVEY SHEET -
DEKALB County, GA

Cemetery FELLOWSHIP PRIMITIVE BAPTIST CHURCH Page 7 / 43

Surveyor TED BROOKE, CUMMING, GA Date 12/11/94

(START OF ROW 3)

Note	Last	First	Middle	Dates dy/mo/year	Other Information
	PHILLIPS	INFANT SONS		B- — D- 20 JAN 1942	INFANT SONS OF BOYD & RUTH PHILLIPS
	GRIFFIN	LAWRENCE		B- 16 OCT 1884 D- 3 JAN 1972	
	HENDERSON	BERTHA MAE GRANT		B- 11 JAN 1879 D- 2 APR 1953	
	HENDERSON	WILLIAM L.		B- 8 JUN 1919 D- 21 MAY 1978	SSGT US ARMY WORLD WAR II
	TURNER	JOHN OLEN		B- 27 JUN 1911 D- 25 OCT 1981	
	ROSSMAN	ELIZABETH TURNER		B- 5 JUL 1921 D- 21 JUL 1994	
	RISTER	INFANT SON		B- 9 FEB 1917 D- 9 FEB 1917	INFANT SON OF J.W. & L.S. RISTER
	SHUMATE	HETTIE EM		B- 24 FEB 1884 D- 22 JAN 1980	
	PARKER	LAURA BRAND		B- 23 DEC 1876 D- 24 NOV 1966	"MOTHER"
	SUMMERLIN	S. ARDELLA		B- 5 AUG 1873 D- 6 MAY 1946	"MOTHER"
	BRAND	LURA		B- 30 SEP 1881 D- 23 AUG 1962	
	BRAND	LILLIE		B- 25 JUN 1883 D- 6 SEP 1928	
D	BRAND	JONAS WASHINGTON		B- 14 MAR 1836 D- 23 MAR 1916	"FATHER"

Notes: _____

Ted O. Brooke
2055 Foster Drive
Cumming, GA 30130

- CEMETERY SURVEY SHEET -
DEKALB County, GA

Cemetery FELLOWSHIP PRIMITIVE BAPTIST CHURCH Page 8 / 43

Surveyor TED BROOKE, CUMMING, GA Date 12/11/94

Note	Last	First	Middle	- Dates - dy/mo/year	Other Information
D	BRAND	ELIZABETH A.	G.	B-15 AUG 1846 D-17 OCT 1912	"MOTHER"
D	BARBER	DELPHIE	E.	B-1868 D-19--	
D	BARBER	WILL	N.	B-1866 D-1946	
	LINDSAY	GUSSIE	CHEWNING	B-9 AUG 1882 D-25 MAY 1942	
	LINDSAY	PAUL	LEONARD	B-16 NOV 1878 D-18 MAY 1944	
	THOMAS	JULIAN	ASHBY	B-11 DEC 1922 D-27 JAN 1984	S2 US NAVY WORLD WAR II
	THOMAS	CLIFFORD	ROBERT	B-4 JUL 1924 D-20 NOV 1976	TECS US ARMY WORLD WAR II
D	THOMAS	SAM		B-24 APR 1897 D-18 OCT 1961	
D	THOMAS	MARION		B-6 OCT 1900 D--	
D	LAWTON	ERNEST	F.	B-18 JUL 1882 D-25 NOV 1976	
D	LAWTON	FANNIE	B.	B-27 JAN 1884 D-15 MAR 1973	
	LAWTON	BEATRICE		B-8 DEC 1903 D-10 APR 1915	DAUGHTER OF E.F. & F.B. LAWTON
				B-	
				D-	

Notes: _____

Ted V. Brooke
 2055 Foster Drive
 Cumming, GA 30130

- CEMETERY SURVEY SHEET -
DEKALB County, GA

Cemetery FELLOWSHIP PRIMITIVE BAPTIST CHURCH Page 9 / 43

Surveyor TED BROOKE, CUMMING, GA Date 12/11/94

Ted O. Brooke
 2055 Foster Drive
 Cumming, GA 30130

Note	Last	First	Middle	- Name -		- Dates -		Other Information
				dy	mo	year		
D	WHITE	JOHNNIE	RUTH	1B-25	NOV	1906		
				1D-				
D	WHITE	HERSCHEL	LEROY	1B-25	NOV	1894		
				1D-30	DEC	1967		
D	REEVES	LUCIUS	G.	1B-30	MAR	1906		
				1D-15	JUN	1988		
D	REEVES	RUTH	N.	1B-27	SEP	1903		
				1D-17	DEC	1987		
	HAZERIG	J. C.	JR.	1B-20	MAY	1923		LITTLE J. C. JR. SON OF
				1D-20	JAN	1927		MAR. & MRS. JOHN CARL
				1B-				(ART-ANGEL -
				1D-				SEE PHOTO)
	HAZERIG	JAMES	E.	1B-1	AUG	1928		SSGT US AIR FORCE
				1D-1	AUG	1991		KOREA
D	JARRELL	ZIPHIAL	C.	1B-31	JUL	1885		"DAD"
				1D-15	OCT	1928		
D	JARRELL	MINNIE	J.	1B-29	OCT	1988		"MOM"
				1D-11	NOV	1990		
U				1B-				
				1D-				
D	JARRELL	GEORGE	F.	1B-3	DEC	1862		
				1D-9	JUN	1944		
D	JARRELL	JOANNA		1B-10	MAR	1866		
				1D-24	DEC	1957		
				1B-				
				1D-				

Notes: _____

- CEMETERY SURVEY SHEET -
DEKALB County, GA

Cemetery FELLOWSHIP PRIMITIVE BAPTIST CHURCH Page 10 / 43

Surveyor TED BROOKE, CUMMING, GA Date 12/11/94

<u>Note</u>	<u>- Name -</u>			<u>- Dates -</u>		<u>Other Information</u>
	<u>Last</u>	<u>First</u>	<u>Middle</u>	<u>dy</u>	<u>mo</u>	<u>year</u>
D	WILLOUGHBY,	GEORGE W.		B-	1875	
				D-	1958	
D	WILLOUGHBY,	PEARL J.		B-	1888	
				D-	1968	
D	JORDAN,	BEATRICE J.		B-	31 AUG 1889	
				D-	15 FEB 1963	
D	JORDAN,	J. LONNIE		B-	14 AUG 1884	
				D-	1 JUL 1966	
D	DILLARD,	ALBERT R.		B-	5 AUG 1910	
				D-	17 DEC 1984	
D	DILLARD,	MATTIE J.		B-	10 MAY 1917	
				D-	-	
	SHUBERT,	JONATHAN		B-	16 MAY 1966	"OUR BELOVED SON"
				D-	30 NOV 1990	"JOHNNY"
	(50 FT. SPACE)			B-		
				D-		
	KEEVER,	JULIA ELLEN		B-	14 JAN 1872	"MOTHER"
				D-	24 APR 1947	
	(END OF ROW 3)			B-		
				D-		
				B-		
				D-		
				B-		
				D-		
				B-		
				D-		

Notes: _____

189 U. Brubaker
 2055 Foster Drive
 Cumming, GA 30130

- CEMETERY SURVEY SHEET -
DEKALB County, GA

Cemetery FELLOWSHIP PRIMITIVE BAPTIST CHURCH Page 11 / 43

Surveyor TED BROOKE, CUMMING, GA Date 12/11/94

Note	Last	First	Middle	Dates dy/mo/year	Other Information
	(START OF ROW 4)			B- D-	
U				B- D-	(3 FT LONG STONE)
U				B- D-	(HEAD & FOOTSTONE)
	NASH,	NANCY A.	PARKER	B-28 OCT 1830 D-16 APR 1916	WIFE OF LARKIN "OUR MOTHER" NASH
U				B- D-	(HEAD & FOOTSTONE)
U				B- D-	(HEAD & FOOTSTONE)
	TURNER,	IDA	DAVID	B-12 FEB 1891 D-18 NOV 1938	"MAMA WE LOVE YOU ALWAYS"
	TURNER,	JOHN	M.	B-22 JUN 1879 D-18 AUG 1927	
	TURNER,	MATTIE	M.	B- D-22 NOV 1911	
D	NORRIS,	WILLIAM	J.	B-17 JUL 1871 D-13 SEP 1956	
D	NORRIS,	MARY D.	(MAMIE)	B-9 FEB 1885 D-8 OCT 1958	
	NORRIS,	JAMES	H.	B-25 MAY 1905 D-16 MAR 1962	GEORGIA - PVT 257 AAA, AW, BN, CAC, WORLD WAR II
	NORRIS,	ROY	LEE	B-15 JUN 1923 D-14 MAY 1928	

Notes: _____

- CEMETERY SURVEY SHEET -
DEKALB County, GA

Cemetery FELLOWSHIP PRIMITIVE BAPTIST CHURCH Page 12/43

Surveyor TED BROOKE, CUMMING, GA Date 12/11/94

Ted O. Brooke
 2055 Foster Drive
 Cumming, GA 30130

Note	- Name -			- Dates -		Other Information
	Last	First	Middle	dy	mo/year	
	NORRIS	GENE	LAMAR	B-15	JAN 1928	SGT, US MARINE CORPS, WORLD WAR II
	WINGATE	ISAAC	NEWTON	B-5	JUL 1920	FCI US NAVY WORLD WAR II
D	SHAW	TILLA		B-16	NOV 1879	
				D-13	FEB 1920	
D	SHAW	J. W.		B-1	JUL 1879	
				D-9	DEC 1952	
	SHAW	SAM J.		B-30	AUG 1911	"BROTHER"
				D-22	SEP 1940	
	SHAW	ROBERT LEE		B-23	FEB 1913	
				D-3	JUN 1981	
	SHAW	CASH W.		B-19	OCT 1899	
				D-4	SEP 1970	
	BALL	LILLIE		B-21	MAY 1900	
				D-26	SEP 1918	
	COWAN	INFANT DAUGHTER		B-14	JUN 1944	INFANT DAUGHTER OF MR. & MRS. T. P. COWAN
				D-14	JUN 1944	
	MOSS	INFANT SON		B-3	APR 1937	INFANT SON OF MR. & MRS. O. N. MOSS
				D-3	APR 1937	
	BALL	FRED LESTER		B-13	OCT 1905	
				D-28	JUN 1983	
D	BALL	WILLIAM L.		B-26	NOV 1971	
				D-15	DEC 1954	
D	BALL	ARMIN DA JORDAN		B-3	MAR 1867	
				D-13	DEC 1952	

Notes: _____

- CEMETERY SURVEY SHEET -
DEKALB County, GA

Cemetery FELLOWSHIP PRIMITIVE BAPTIST CHURCH Page 13 / 43

Surveyor TED BROOKE, CUMMING, GA Date 12/11/94

Note	Last	First	Middle	- Dates - dy/mo/year	Other Information
	KOOTZ,	ORA	BAU	B-19 JUN 1895 D-21 AUG 1916	WIFE OF J. H. KOOTZ
	KOOTZ,	JULIUS	H.	B-15 JUN 1891 D-6 APR 1959	
	KOOTZ,	REBA	S.	B-25 OCT 1897 D-26 OCT 1960	
	KOOTZ,	JOHN		B-20 APR 1854 D-19 SEP 1923	
	KOOTZ,	JULIA		B-20 JUL 1854 D-4 DEC 1916	"MOTHER" WIFE OF JOHN KOOTZ,
D	SIMPKINS,	MINNIE	R.	B-(1873-1874) D-15 MAR 1911	WIFE OF B. J. SIMPKINS "AGE 37 YEARS"
D	SIMPKINS,	CARLOS		B- D-15 FEB 1911	"THEIR SON"
D	HALE,	THOMAS	J.	B-1856 D-1938	
D	HALE,	MARY	E.	B-1861 D-1945	
T	TAYLOR,	FRANK	J.	B-3 JAN 1859 D-18 APR 1938	FATHER
T	TAYLOR,	SALLIE	M.	B-16 AUG 1959 D-22 DEC 1942	MOTHER
T	TAYLOR,	MARYL		B-12 DEC 1898 D-11 NOV 1920	SISTER
	SIMS,	JACQUOLYN TAYLOR		B-7 OCT 1936 D-13 MAR 1981	MOTHER "JACKIE"

Notes: _____

Ted O. Brooke
 2055 Foster Drive
 Cumming, GA 30130

- CEMETERY SURVEY SHEET -
DEKALB County, GA

Cemetery FELLOWSHIP PRIMITIVE BAPTIST CHURCH Page 14 / 43

Surveyor TED BROOKE, CUMMING, GA Date 12/11/94

Note	- Name -			- Dates -		Other Information
	Last	First	Middle	dy	mo/year	
T	TAYLOR	FRANK F.		B-22	JAN 1902	FATHER
				D-2	JUL 1993	
T	TAYLOR	MARY ELIZA		B-20	NOV 1901	MOTHER
				D-		
T	TAYLOR	INFANT DAUGHTER		B-		BABY
				D-31	MAY 1923	
D	BRAND	LYMAN J.		B-11	JUL 1891	ELDER
				D-21	MAY 1958	
D	BRAND	INEZ C.		B-9	FEB 1902	
				D-		
	HUCKS	ELLA CORINNE		B-22	AUG 1880	MOTHER
				D-8	FEB 1974	
D	WEBB	HELENA		B-1884		MOTHER
				D-1934		
D	WEBB	CARL O.		B-1885		FATHER
				D-1936		
D	CHEWNING	WILLIAM A.		B-11	JAN 1872	
				D-5	JUL 1937	
D	CHEWNING	MARY E.		B-13	AUG 1877	
				D-4	SEP 1963	
	CHEWNING	M. J.		B-18	JUN 1878	
				D-20	DEC 1945	
	CHEWNING	ANNIE T.		B-11	SEP 1882	
				D-28	JUL 1967	
				B-		
				D-		

Notes: _____

Ted O. Brooke
 2055 Foster Drive
 Cumming, GA 30130

- CEMETERY SURVEY SHEET -
DEKALB County, GA

Cemetery FELLOWSHIP PRIMITIVE BAPTIST CHURCH Page 15 / 43

Surveyor TED BROOKE, CUMMING, GA Date 12/11/94

Note	- Name -			- Dates -		Other Information
	Last	First	Middle	dy	mo/year	
	BARNES,	MRS. BLONNIE L.		B-1	JAN 1916	AGED 76 YEARS, 2 DAYS
				D-3	JAN 1992	(HENRY FUNERAL HOME)
D	SCHWEIZER,	ALFRED		B-27	MAR 1887	
				D-		
D	SCHWEIZER,	FRANCES		B-8	JUN 1888	
		KOUTZ		D-23	APR 1968	
	MOORE,	LOUIS J.		B-28	JAN 1907	GEORGIA
				D-1	OCT 1973	PFC US ARMY WORLD WAR II
	MOORE,	MARY CELIA		B-1	APR 1913	
				D-8	APR 1972	
	COWN (PLOT - NO OTHER NAMES)					
	(END OF ROW 4 - START OF ROW 5)					
	TURNER,	CARRIE E.		B-	1876	
				D-	1917	
	BROWNING,	T.A.		B-26	DEC 1829	
				D-27	SEP 1896	
	LIETCH,	S.A.		B-18	FEB 1824	
				D-22	JUN 1901	
	LIETCH,	SUSAN		B-9	NOV 1855	"LIETCH" ON BASE
				D-10	NOV 1926	
D	MORRIS,	WILLIAM A.		B-18	41	
				D-19	20	
D	MORRIS,	CYNTHIA E.		B-18	39	
				D-19	25	

Notes: _____

- CEMETERY SURVEY SHEET -
DEKALB County, GA

Cemetery FELLOWSHIP PRIMITIVE BAPTIST CHURCH Page 16 / 43

Surveyor TED BROOKE, CUMMING, GA Date 12/24/94

Ted O. Brooke
 2055 Foster Drive
 Cumming, GA 30130

Note	Last	First	Middle	- Name -	- Dates -	Other Information
					dy/mo/year	
	MORRIS	JOHN	J.		B- 1870 D- 1950	
	COCHRAN	LULA			B- 3 NOV 1886 D- 19 MAY 1951	"MOTHER"
	WRIGHT	DAVIS	P.		B- 21 JUL 1863 D- 10 JUL 1889	"WRIGHT" ON BASE (F = "D.P.W.")
	WRIGHT	W.	GLEN		B- 2 JAN 1887 D- 27 OCT 1936	(F = "W.G.W.")
	NORRIS	HOMER	DEWITT		B- 7 APR 1917 D- 13 OCT 1918	
	NORRIS	EULA	MAY		B- 20 JAN 1904 D- 25 JAN 1904	DAU OF MR. & MRS. W. J. NORRIS
	DICKENS	INFANT	SON		B- 9 JAN 1890 D- 16 JAN 1890	INFANT SON OF MR. & MRS. J.T. DICKENS
	DICKENS	INFANT	SONS		B- - D- 9 JAN 1890	INFANT SONS OF MR. & MRS. J.T. DICKENS
D	DICKENS	MARY	A.		B- 15 NOV 1897 D- 28 DEC 1988	F = "MOTHER"
D	DICKENS	JAMES	C.		B- 19 JAN 1889 D- 6 NOV 1971	
F	DICKEN(sic)	JAMES	C.		B- 19 JAN 1889 D- 6 NOV 1971	GEORGIA, PFC US ARMY, WORLD WAR I
	DICKENS	MR. & MRS.	J.C.		B- - D- -	(MKA AT CORNER OF PLOT)
	BURNETT	EMILY	KATE		B- 30 MAY 1882 D- 4 DEC 1914	DAU. OF MR. & MRS. G.T. HOPKINS

Notes: _____

- CEMETERY SURVEY SHEET -
DEKALB County, GA

Cemetery FELLOWSHIP PRIMITIVE BAPTIST CHURCH Page 17 / 43

Surveyor TED BROOKE, CUMMING, GA Date 12/24/94

Note	- Name -			- Dates -		Other Information
	Last	First	Middle	dy	mo/year	
	BROOKS	MAMIE V.		B-15 DEC 1869		WIFE OF J. H. BROOKS
				D-24 AUG 1890		
	HOPKINS	DAUGHTER		B-3 JUL 188-		(MARR BROKEN) DAUGHTER OF G. T. & M. H. HOPKINS"
				D- (DEATH DATE PIECE MISSING)		"AGED 5 YEARS, 3 MOS. & 8 DS"
	HOPKINS	LONA		B-3 APR 1875		(MARR BROKEN)
				D-10 JUL 1897		
	HOPKINS	MARGARET H.		B-26 SEP 1842		"WIFE OF GREEN T. HOPKINS"
				D-23 MAY 1920		
	HOPKINS	GREEN THOMAS		B-10 APR 1838		
				D-23 AUG 1908		
	CHEWNING	CHARLES L.		B-26 JUN 1867		"HUSBAND OF (F= JANIE CHEWNING" "C.L.C.")
				D-4 NOV 1911		
U	(UNINSCRIBED FLAT UPRIGHT SLAB, BUT FLOWERS HERE)			B-		
				D-		
U	(ditto)			B-		
				D-		
U	(ditto)			B-		
				D-		
	ESTES	INFANT DAUGHTER		B- -		INFANT DAU. OF MR. & MRS. J. C. ESTES
				D-13 NOV 1909		
T	ESTES	F. CLARK		B-21 FEB 1901		"KKK" EMBLEM
				D-17 AUG 1922		"SON" F="D.O.F.A."
T	ESTES	HATTIE E.		B-15 MAR 1871		"MOTHER"
				D-26 DEC 1945		"MARRIED 3 APR 1892"

Notes: _____

- CEMETERY SURVEY SHEET -
DEKALB County, GA

Cemetery FELLOWSHIP PRIMITIVE BAPTIST CHURCH Page 18 / 43

Surveyor TED BROOKE, CUMMING, GA Date 12/24/94

Note	Last	First	Middle	- Dates - dy/mo/year	Other Information
T	ESTES	JABEZ	C.	B-27 MAR 1870 / D-19 OCT 1958	"FATHER" (MASONIC EMBLEM)
U				B- / D-	
D	BRAND	BERT	B.	B-24 SEP 1885 / D-15 APR 1970	
D	BRAND	ETHEL	L.	B-12 JUL 1886 / D-2 JAN 1965	
D	CASH	GROVER	C.	B-24 JUL 1886 / D-16 SEP 1973	
D	CASH	MANON	ESTES	B-9 OCT 1894 / D-1 DEC 1942	
D	HESTER	H. GRADY		B-14 JUN 1893 / D-25 MAY 1963	"MARRIED 2 AUG 1914"
D	HESTER	VERA	E.	B-7 JAN 1893 / D-2 JAN 1989	
	HAYNIE	WALTER	LEE	B-12 JUL 1912 / D-2 MAR 1994	
	HAYNIE	MARGARET	BRAND	B-14 SEP 1912 / D-	
D	WEBB	CLYDE	A.	B-6 NOV 1898 / D-27 OCT 1971	F = "PA"
D	WEBB	HELEN	B.	B-7 DEC 1907 / D-18 DEC 1987	F = "MOTHER"
				B- / D-	
				B- / D-	

Notes: _____

Ted O. Brooke
 2055 Foster Drive
 Cumming, GA 30130

- CEMETERY SURVEY SHEET -
DEKALB County, GA

Cemetery FELLOWSHIP PRIMITIVE BAPTIST CHURCH Page 19 / 43

Surveyor TED BROOKE, CUMMING, GA Date 12/26/94

Note	- Name -			- Dates -		Other Information
	Last	First	Middle	dy	mo/year	
	READ,	CHARLES DAY JR,		B-30 MAY 1920	D-4 DEC 1992	LT COL, US ARMY AIR CORPS, WORLDWARR II
D	DOAK,	EARL R.		B-12 FEB 1895	D-21 JAN 1972	F= FATHER
D	DOAK,	FRANCES C.		B-21 JUL 1894	D-26 AUG 1978	F= MOTHER
	GARVEY,	PAUL HURIGAN		B-6 JAN 1885	D-22 AUG 1949	
	GARVEY,	IRENE LEWIS		B-16 JUL 1896	D-19 DEC 1979	
	BRAND,	INFANT SON		B-	D-13 DEC 1948	INFANT SON OF MR, & MRS. J. F. BRAND
	JONES,	EMMIE C.		B-1867	D-1947	WIFE OF J. E. JONES
D	LEWIS,	HUGH SIMPSON		B-30 JAN 1899	D-23 MAY 1987	
D	LEWIS,	KATHERINE GORMAN		B-2 OCT 1908	D-29 MAR 1982	
(END OF ROW 5, START OF ROW 6)						
	RALSTON,	ERNEST RONALD		B-9 SEP 1947	D-14 OCT 1947	
	HENDERSON,	LUCY J.		B-15 JUN 1848	D-21 JUN 1890	"MOTHER"
	HUDSON,	LENA B.		B-10 JAN 1888	D-18 JAN 1888	DAU. OF F. P. & S. A. HUDSON (MKA BROKEN)

Notes: _____

Ted U. Brooke
 2055 Foster Drive
 Cumming, GA 30130

- CEMETERY SURVEY SHEET -
DEKALB County, GA

Cemetery FELLOWSHIP PRIMITIVE BAPTIST CHURCH Page 20 / 43

Surveyor TED BROOKE, CUMMING, GA Date 12/26/94

Note	- Name -			- Dates -		Other Information
	Last	First	Middle	dy	mo/year	
	HUDSON	OLIVE	W.	B- 9	NOV 1888	DAU. OF F.P. & S.A.
				D- 18	MAR 1891	HUDSON (MKR REPAIRED)
	HUDSON	SARAH	A.	B- 20	OCT 1867	WIFE OF F.P. HUDSON
				D- 25	MAR 1889	(MKR REPAIRED)
D	HUDSON	LOU	DOVIA	B- 24	FEB 1861	WIFE OF F.P. HUDSON
				D- 31	DEC 1907	
D	HUDSON	SARAH	A.	B- 28	OCT 1867	WIFE OF F.P. HUDSON
				D- 25	MAR 1889	
	C,	E,		B- -	-	(INFANT PLOT - ONLY
				D- -	-	INITIALS "E.C.")
D	CHEWNING	D.P.		B- 1	FEB 1861	
				D- 31	MAR 1917	
D	CHEWNING	HATTIE	A.	B- 3	SEP 1867	
				D- 9	APR 1954	
D	CHEWNING	A.G.		B- 18	MAY 1865	F = FATHER
				D- 16	OCT 1938	
D	CHEWNING	DELILAH	D.	B- 14	OCT 1880	F = MOTHER
				D- 15	JUN 1972	
	LINDSAY	SAM	H.	B- 6	DEC 1914	
				D- 4	JAN 1920	
D	LINDSAY	CLARENCE	B.	B- 12	OCT 1875	
				D- 20	NOV 1954	
D	LINDSAY	OLA	E.	B- 23	JAN 1890	
				D- 15	DEC 1961	
	(LINDSAY)	INFANT		B- -	-	
				D- -	-	

Notes: _____

Ted O. Brooke
 2055 Foster Drive
 Cumming, GA 30130

- CEMETERY SURVEY SHEET -
DEKALB County, GA

Cemetery FELLOWSHIP PRIMITIVE BAPTIST CHURCH Page 21 / 43

Surveyor TED BROOKE, CUMMING, GA Date 12/26/94

Note	- Name -			- Dates -		Other Information
	Last	First	Middle	dy	mo/year	
	(LINDSAY)	INFANT		B-	-	
	(LINDSAY)	INFANT		D-	-	
	LINDSAY	ROBERT E.		B-	8 MAY 1925	S1 US NAVY
				D-	6 DEC 1983	WORLD WAR II
	DICKENS	DOROTHY ESTES		B-	-	
				D-	12 OCT 1962	
D	BENNETT	JOHN W.		B-	1852	
				D-	1930	
D	BENNETT	DELILIANA		B-	1857	
				D-	1945	
	BENNETT	NEWMAN C.		B-	22 OCT 1883	
				D-	19 DEC 1931	
(GAZEBO AT THIS POINT: FOLLOWING MKR IS WITHIN!)						
D	LEWIS	CORA W.		B-	11 NOV 1875	F = MOTHER
				D-	21 MAY 1949	
D	LEWIS	GRAY R.		B-	8 JAN 1876	F = FATHER
				D-	23 FEB 1933	
	KING	GRACE PARRISH		B-	1898	
				D-	1939	
D	PARRISH	SAMUEL JOSEPH		B-	6 MAR 1873	"REV."
				D-	21 JUL 1947	
D	PARRISH	MAUDE STEWART		B-	26 FEB 1877	
				D-	14 MAR 1968	

Notes: _____

160 V. Blinn
 2055 Foster Drive
 Cumming, GA 30130

- CEMETERY SURVEY SHEET -
DEKALB County, GA

Cemetery FELLOWSHIP PRIMITIVE BAPTIST CHURCH Page 22 / 43

Surveyor TED BROOKE, CUMMING, GA Date 12/26/94

Note	- Name -			- Dates -		Other Information
	Last	First	Middle	dy	mo/year	
	RANDOLPH,	C. ED		B-7 SEP	1924	AFC US NAVY WORLD WAR II
D	RANDOLPH,	CHARLES A.		B-18 MAR	1887	
				D-3 FEB	1966	
D	RANDOLPH,	FLORENCE M.		B-17 APR	1887	
				D-22 NOV	1956	
	GADDIS,	CHARLES WILLIAM		B-1871		
				D-1944		
	GADDIS,	CARRIE LEE		B-1875		
				D-1948		
	DERN,	JOHN SHERMAN		B-1891		
				D-1950		
	DERN,	PEGGY GADDIS		B-1895		
				D-1966		
→ D	CHESNUT,	JOHN ROY		B-16 JUN	1895	≡
				D-3 OCT	1968	
D	CHESNUT,	ETTIE BELL		B-14 JUL	1903	
				D-		
F	CHESNUT,	JOHN ROY		B-16 JUN	1895	S2 US NAVY WORLD WAR I
				D-3 OCT	1968	
	CHESNUT,	HENRY D.		B-23 MAY	1921	
				D-20 SEP	1991	
(END OF ROW 6, START				B-	OF ROW 7)	
				D-		
				B-		
				D-		

Notes: _____

Ted O. Brooke
2055 Foster Drive
Cumming, GA 30130

- CEMETERY SURVEY SHEET -
DEKALB County, GA

Cemetery FELLOWSHIP PRIMITIVE BAPTIST CHURCH Page 23 / 43

Surveyor TED BROOKE, CUMMING, GA Date 12/26/94

Note	- Name -			- Dates -		Other Information
	Last	First	Middle	dy	mo/year	
	JORDAN	ANGIE	MILES	B-19	JUN 1898	
				D-19	NOV 1959	
	THURMAN	LEONA	JORDAN	B-23	NOV 1908	
				D-26	JUL 1927	
	JORDAN	MAMIE		B-15	MAR 1913	
				D-19	JAN 1926	
	JORDAN	CURTIS		B-23	NOV 1905	
				D-8	JAN 1906	
	JORDAN	SALLIE		B-26	MAR 1860	WIFE OF
				D-5	MAR 1892	J. H. JORDAN
	JORDAN	WILLIE		B-19	SEP 1891	
				D-30	OCT 1891	
	JORDAN	JAMES	HAMILTON	B-30	OCT 1856	
				D-25	NOV 1934	
	WRIGHT	LUCY		B-	(1799)	WIFE OF WM. WAIGHT
				D-	1889	AGE ABOUT 90 YRS.
u	(ROCK)			B-	(ON REVERSE = "MOTHER")	
				D-		
u	(ROCK)			B-		
				D-		
	FRAZIER	MARTHA		B-5	JUL 1856	
		McELROY		D-28	JUN 1929	
	TALBOT	M. B.		B-18	41	"DR."
				D-2	DEC 1925	
	WESTBROOK	MARY J.		B-21	SEP 1848	
				D-9	JAN 1883	

Notes: _____

- CEMETERY SURVEY SHEET -
DEKALB County, GA

Cemetery FELLOWSHIP PRIMITIVE BAPTIST CHURCH Page 24 / 43

Surveyor TED BROOKE, CUMMING, GA Date 12 / 26 / 94

Note	- Name -			- Dates -		Other Information
	Last	First	Middle	dy	mo/year	
	WELLS,	JAMES A,		B-11	MAY 1847	"FATHER"
				D-27	MAY 1933	
	WELLS,	MARY JANE		B-21	APR 1843	"MOTHER"
				D-20	JUL 1922	
T	HUDSON,	SARAH E.		B-18	OCT 1869	DAUGHTER OF G. B. &
				D-10	APR 1889	S. E. HUDSON
T	HUDSON,	GEORGE B.		B-6	MAR 1823	CAPT., CO. F
				D-20	AUG 1884	36 REGT GA VOL
T	HUDSON,	SARAH E. McDANIEL		B-13	JUL 1829	WIFE OF GEO, B,
				D-19	FEB 1910	HUDSON
	CHEWNING,	INFANT		B-24	FEB 1900	INFANT OF MR. &
				D-24	FEB 1900	MRS, A. G, CHEWNING
D	CHEWNING,	RICHMOND A.		B-24	FEB 1838	"FATHER AND
				D-22	JAN 1907	MOTHER"
D	CHEWNING,	ELIZA E.		B-24	NOV 1840	
				D-10	JAN 1912	
	CHEWNING,	EUNICE		B-12	APR 1904	("ROLL" TYPE MKR-
				D-26	MAR 1909	SEE PIC)
	CHEWNING,	OWEN		B-5	OCT 1901	
				D-16	JUL 1909	
	CHEWNING,	MAURICE E.		B-25	SEP 1908	
				D-1	OCT 1910	
	JOLEY,	JOSEPH H.		B-29	OCT 1854	(MKR BROKEN)
				D-3	MAR 1921	
	"NASH"	(PLOT ONLY -		B-		INDIVIDUAL MARKERS)

Notes: _____

Ted O. Brooke
 2055 Foster Drive
 Cumming, GA 30130

- CEMETERY SURVEY SHEET -
DEKALB County, GA

Cemetery FELLOWSHIP PRIMITIVE BAPTIST CHURCH Page 25 / 43

Surveyor TED BROOKE, CUMMING, GA Date 12/26/94

Note	- Name -			- Dates -		Other Information	
	Last	First	Middle	dy	mo	year	
D	CHEWNING	CARMON	LESTER	B-	6	SEP 1889	FATHER
				D-	14	MAY 1961	
D	CHEWNING	PAULA	TAYLOR	B-	12	SEP 1882	MOTHER
				D-	6	SEP 1947	
	CHEWNING	EDITH	LUCY	B-	29	DEC 1918	SISTER
				D-	7	DEC 1934	
D	MOORE	CHARLIE		B-		1877	
				D-		1937	
D	MOORE	MYRTICE		B-		1884	
				D-		1934	
U	(MARBLE)			B-			
				D-			
U	(MARBLE)			B-			
				D-			
D	THOMPSON	A.	RILEY	B-		1861	
				D-		1934	
D	THOMPSON	IDA	F.	B-		1872	
				D-		1955	
	HANNAH	ROBERT		B-		1918	
				D-		1944	
D	HANNAH	ETSEL	F.	B-	20	JAN 1882	F = FATHER
				D-	7	NOV 1950	
D	HANNAH	SARAH	A.	B-	3	MAR 1886	F = MOTHER
				D-	30	MAR 1975	
				B-			
				D-			

Notes: _____

Ted O. Brooke
 2055 Foster Drive
 Cumming, GA 30130

- CEMETERY SURVEY SHEET -
DEKALB County, GA

Cemetery FELLOWSHIP PRIMITIVE BAPTIST CHURCH Page 26 / 43

Surveyor TED BROOKE, CUMMING, GA Date 12/26/94

Note	Last	First	Middle	B- dy	D- mo/year	Other Information
D	HANNAH	PAUL L.		B-21	NOV 1908	F = DADDY
				D-10	OCT 1975	
D	HANNAH	HAZEL M.		B-31	AUG 1913	F = MOTHER
				D-29	APR 1989	
		GREER	BILLY	B-2	SEP 1943	
				D-12	NOV 1945	
D	WOMACK	JOHN E.		B-1889		
				D-1962		
D	WOMACK	MARY BURNICE		B-1891		
				D-1962		
END OF ROW 7, START OF ROW 8						
				B- D-		NO INDIVIDUAL MARKERS -
				B- D-9)		SEE START OF ROW 9)
	BROOKS	RUBY		B-		DAU. OF MR. & MRS.
				D-		G, W, BROOKS
U	(FLAT	ROCK)		B-		
				D-		
U	(ROCK)			B-		
				D-		
U	(ROCK)			B-		
				D-		
	HAYNIE	J. F.		B-		"BIRTH UNKNOWN"
				D-13	DEC 1892	

Notes: _____

Ted O. Brooke
 2055 Foster Drive
 Cumming, GA 30130

- CEMETERY SURVEY SHEET -
DEKALB County, GA

Cemetery FELLOWSHIP PRIMITIVE BAPTIST CHURCH Page 27 / 43

Surveyor TED BROOKE, CUMMING, GA Date 12/26/94

Note	- Name -			- Dates -		Other Information	
	Last	First	Middle	dy	mo	year	
	MITCHELL	ANNAH	L.	B-	8	APR 1851	WIFE OK GEO. W. MITCHELL
				D-	12	JUN 1909	
	MITCHELL	GEORGE		B-	22	JUL 1849	(MARR BROKEN)
		WASHINGTON		D-	30	JUN 1895	
U	(MARBLE)			B-			
				D-			
	WARREN	REBECCA	C.	B-	10	DEC 1819	F = "R. C. W."
				D-	7	JAN 1905	AGE 85 YRS.
U				B-			
				D-			
U				B-			
				D-			
	KIMBAELL	MARTHA	K.	B-	1	JUL 1818	(MARR BROKEN)
				D-	15	FEB 1891	F = "M. K."
U	(ROCK)			B-			
				D-			
U	(ROCK)			B-			
				D-			
U	(ROCK)			B-			
				D-			
D	WEBB	J. W.		B-	31	MAR 1849	
				D-	7	NOV 1926	
D	WEBB	S. J. L.		B-	16	MAR 1854	
				D-	28	JAN 1938	
	QUINN	IDA	WEBB	B-	20	MAR 1880	DAU. OF J. W. WEBB
				D-	13	OCT 1909	

Notes: _____

Ted O. Brooke
 2055 Foster Drive
 Cumming, GA 30130

- CEMETERY SURVEY SHEET -
DEKALB County, GA

Cemetery FELLOWSHIP PRIMITIVE BAPTIST CHURCH Page 28 / 43

Surveyor TED BROOKE, CUMMING, GA Date 12/26/94

Note	- Name -			- Dates -		Other Information
	Last	First	Middle	dy	mo/year	
	WEBB,	LILLIE		B-28	JUL 1878	
				D-30	APR 1967	
	QUINN,	CLEVELAND	C.	B-14	OCT 1901	
				D-4	DEC 1968	
U	(ROCK)			B-		
				D-		
D	WARREN,	J. E. B.		B-29	DEC 1856	
				D-30	SEP 1921	
D	WARREN,	MRS. J. E. B.		B-1	SEP 1859	
				D-		
	FALKNER,	BENJ. F.		B-22	FEB 1869	
				D-27	APR 1927	
	FALKNER,	LOVELLA		B-15	AUG 1883	MOTHER
				D-40	OCT 1940	
D	McCONNELL,			B-25	MAR 1890	
		O. G. (Mac) SR.		D-8	AUG 1937	
D	McCONNELL,			B-23	JUL 1896	
		GRACE E.		D-		
D	HOPPERS,	ANNE E.		B-4	JAN 1875	
				D-5	MAY 1952	
D	HOPPERS,	JAMES D.		B-23	JAN 1869	
				D-31	MAR 1937	
D	FLOWERS,	RALPHE,		B-30	NOV 1898	F = FATHER
				D-26	OCT 1978	
D	FLOWERS,	NINA M.		B-21	DEC 1897	F = MOTHER
		ANDREWS		D-10	MAR 1936	

Notes: _____

Ted O. Brooke
 2055 Foster Drive
 Cumming, GA 30130

- CEMETERY SURVEY SHEET -
DEKALB County, GA

Cemetery FELLOWSHIP PRIMITIVE BAPTIST CHURCH Page 29 / 43

Surveyor TED BROOKE, CUMMING, GA Date 12/26/94

Ted O. Brooke
2055 Foster Drive
Cumming, GA 30130

Note	- Name -			- Dates -		Other Information
	Last	First	Middle	dy	mo/year	
D	WHITAKER,	DAVID		B-	8 DEC 1883	F = FATHER
		ARNOLD		D-	19 FEB 1945	
D	WHITAKER,	ELAH MAE		B-	24 JAN 1889	F = MOTHER
				D-	19 JUL 1972	
	WHITAKER,	BEN W,		B-	29 SEP 1918	PFC US ARMY WORLD WAR II
				D-	29 MAR 1991	
D	GREER,	NELLIE M,		B-	1889	F = MOTHER
				D-	1956	
D	GREER,	WILL A,		B-	1890	F = FATHER
				D-	1971	
	FLOWERS,	EMMETT E,		B-	10 MAY 1892	
				D-	6 OCT 1959	
	FLOWERS,	WILLIE MAE		B-	1 MAY 1894	
				D-	9 SEP 1974	
	DAVIS,	EMMA RUTH		B-	11 OCT 1917	
				D-	26 NOV 1959	
	FLOWERS,	E, LESLIE		B-	8 NOV 1915	
				D-	12 AUG 1985	
(END OF ROW 8, START OF ROW 9)						
	BURNS,	PIERCE K,		B-	16 OCT 1890	
				D-	3 SEP 1971	
	BURNS,	WILLARD V,		B-	23 MAY 1856	FATHER
				D-	9 OCT 1921	
	BURNS,	ALICE KEWEY		B-	13 JAN 1856	MOTHER
				D-	21 JAN 1946	

Notes: _____

- CEMETERY SURVEY SHEET -
DEKALB County, GA

Cemetery FELLOWSHIP PRIMITIVE BAPTIST CHURCH Page 30 / 43

Surveyor TED BROOKE, CUMMING, GA Date 12/26/94

Ted O. Brooke
 2055 Foster Drive
 Cumming, GA 30130

Note	- Name -			- Dates -		Other Information
	Last	First	Middle	dy	mo/year	
	BURNS,	EARNEST B,		B-	2 MAR 1881	BROTHER
				D-	24 SEP 1894	
U	(MARBLE,	POINTED)		B-		
				D-		
	WRIGHT,	AUNT SUSAN		B-	-	(MKR BROKEN)
		AND MARY SAVILLA		D-	-	
		WRIGHT		B-		
U	(MARBLE,	POINTED)		D-		
	BRITT			B-	5 SEP 1850	WIFE OF N. J.,
	BRITT , LOUISE	JOURDAN		D-	30 AUG 1895	BRITT
	BRITT,	N. J.,		B-	17 JUN 1838	
				D-	11 FEB 1916	
U	(MARBLE,	UPRIGHT)		B-		
				D-		
U	(MARBLE	UPRIGHT)		B-		
				D-		
	ALMAND,	B. F. SR.		B-	29 OCT 1857	FATHER
				D-	24 JAN 1941	
	ALMAND,	VICTOR		B-	9 JAN 1897	SUN OF B. F. & D. M.,
				D-	14 NOV 1897	ALMAND
	ALMAND,	DORA M.		B-	12 JUL 1865	MOTHER
				D-	20 FEB 1943	
	KELLEY,	CECIL E,		B-	6 AUG 1902	
				D-	24 OCT 1981	
	KELLEY,	ELSIE A.		B-	4 JUN 1899	
				D-	-	

Notes: _____

- CEMETERY SURVEY SHEET -
DEKALB County, GA

Cemetery FELLOWSHIP PRIMITIVE BAPTIST CHURCH Page 31 / 43

Surveyor TED BROOKE, CUMMING, GA Date 12/26/94

Note	- Name -			- Dates -		Other Information
	Last	First	Middle	dy	mo/year	
	RAY	REBIE		B-	-	INFANT DAU. OF O.O. & LOLA C. RAY
				D-	1918	
D	RAY	CLEMMIE H.		B-	1863	
				D-	1927	
D	RAY	WILLIAM R.		B-	1862	
				D-	1910	
	HAZELRIGS	ELIZABETH		B-	12 AUG 1844	
				D-	28 JUL 1928	
	HAZELRIGS	BENJAMIN F.		B-	18 DEC 1835	
				D-	7 OCT 1897	
	MASSEY	OLA A.		B-	15 MAR 1907	DAU. OF T.R. & I.D. MASSEY
				D-	4 AUG 1908	
	MASSEY	CORA		B-	3 AUG 1895	LITTLE CORA, DAU. OF T.R. & E. MASSEY
				D-	10 AUG 1896	
	MASSEY	EMILY A.		B-	12 JAN 1865	MAKING BROKEN, LYING FLAT ON GROUND
				D-	15 JUN 1903	"WIFE OF T.R. MASSEY"
	MASSEY	BENNIE & EMMIE		B-	-	INFANTS OF T.R. & DORA MASSEY
				D-	2 DEC 1909	
	HAZELRIGS	SAMUEL P.		B-	22 FEB 1880	AGE 22 YRS, 13 DYS.
				D-	7 MAR 1902	
	MASSEY	LOUVENIA		B-	12 NOV 1877	
				D-	20 JUN 1951	
	MASSEY	DORA		B-	9 APR 1875	WIFE OF T.R. MASSEY
				D-	21 FEB 1910	
	MASSEY	THOMAS R.		B-	9 APR 1862	FATHER
				D-	25 JUL 1936	

Notes: _____

Ted O. Brooke
 2055 Foster Drive
 Cumming, GA 30130

- CEMETERY SURVEY SHEET -
DEKALB County, GA

Cemetery FELLOWSHIP PRIMITIVE BAPTIST CHURCH Page 32 / 43

Surveyor TED BROOKE, CUMMING, GA Date 12/26/94

Note	Last	First	Middle	- Name - dy/mo/year	- Dates - dy/mo/year	Other Information
	MASSEY	ROLLEIGH		B-6 AUG 1920 D-19 SEP 1920		TWIN SON OF TR. & L.V. MASSEY
	HAZLERIGS	MINNIE U.		B-18 AUG 1887 D-30 JAN 1905		(MGR BROKEN)
	HAZLERIG	RUBY MAY		B-28 JUL 1907 D-12 OCT 1918		
	HAZELRIG	LIZZIE ATKINSON		B-14 FEB 1892 D-25 SEP 1933		WIFE OF W.N. HAZELRIG
	HAZELRIG	WM. NOAH		B-12 JUN 1864 D-8 DEC 1947		
	HAZELRIG	(INFANT)		B- D-		(MGR BROKEN - LYING FLAT) - OF MR. & MRS. C.D. HAZELRIG
	HAZELRIG	LUTHER G.		B-25 APR 1890 D-9 FEB 1925		
	HAOLEY	CHARLES RAY		B-26 SEP 1930 D-27 NOV 1933		
	SIMPSON	JOSEPH W.		B- 1911 D-1941		
	SIMPSON	ANNIE		B-16 SEP 1892 D-9 APR 1988		
		MAE WEBB				
	BRAND	E.L.		B-5 FEB 1879 D-30 MAY 1941		
	BRAND	MAMIE T.		B-8 MAY 1887 D-8 FEB 1974		
				B- D-		

Notes: _____

Ted O. Brooke
 2055 Foster Drive
 Cumming, GA 30130

- CEMETERY SURVEY SHEET -
DEKALB County, GA

Cemetery FELLOWSHIP PRIMITIVE BAPTIST CHURCH Page 33 / 43

Surveyor TED BROOKE, CUMMING, GA Date 12/26/94

Note	- Name -			- Dates -		Other Information
	Last	First	Middle	dy	mo/year	
	BENNETT	LOYD A.		B-	29 DEC 1896	
				D-	13 MAY 1963	
	BENNETT	LIZAR J.		B-	17 JUL 1878	
				D-	1 SEP 1965	
D	FRAZIER	JULIUS		B-	12 JUL 1918	
				D-	20 OCT 1976	
D	FRAZIER	MITTIE F.		B-	19 JUL 1891	
				D-	-	
D	AYERS	L. ETHAN		B-	14 NOV 1886	(MASONIC EMBLEM)
				D-	16 APR 1961	
D	AYERS	ORA B.		B-	4 SEP 1884	
				D-	8 NOV 1965	
D	RICHARDSON	VEE A.		B-	4 OCT 1913	
				D-	-	
D	RICHARDSON	OSCAR P.		B-	4 OCT 1913	
				D-	10 AUG	
	RICHARDSON	OSCAR		B-	10 AUG 1913	US ARMY
		POUNDS		D-	30 JUL 1992	WORLD WAR II
(END OF ROW 9, START OF ROW 10)						
D	ESTES	B. CLEMENT		B-	1875	
				D-	1966	
D	ESTES	ANNA M.		B-	1878	
				D-	1923	
	MORTON	DEWITT T.		B-	29 APR 1892	
				D-	29 JUN 1893	

(6 UNIDENTIFIED MKRS IN THIS PLOT)

Notes:

Ted O. Brooke
2055 Foster Drive
Cumming, GA 30130

- CEMETERY SURVEY SHEET -
DEKALB County, GA

Cemetery FELLOWSHIP PRIMITIVE BAPTIST CHURCH Page 34 / 43

Surveyor TED BROOKE, CUMMING, GA Date 12/26/94

Ted O. Brooke
2055 Foster Drive
Cumming, GA 30130

Note	- Name -			- Dates -		Other Information
	Last	First	Middle	dy	mo/year	
	JORDAN	S. A.		B-28 FEB	1825	(MKR BROKEN)
				D-23 JUN	1907	
	JORDAN	R. M.		B-12 AUG	1827	
				D-24 MAY	1920	
	JORDAN	GEORGIA		B-19 OCT	1852	
				D-13 MAY	1909	
	"ENGLAND" PLOT (LARGE MARBLE MARKER)					
	ENGLAND	GEORGE M.		B-31 MAY	1854	
				D-25 JAN	1927	
	ENGLAND	LAURA C.		B-5 JAN	1858	
				D-8 JUN	1924	
	WHITFIELD	LENORA		B-29 MAR	1877	WIFE OF C. E. WHITFIELD, M.D.
				D-2 OCT	1907	DAU. OF G. M. & L. C. ENGLAND,
	(8 FT. HIGH OBELISK WITH "WHITFIELD" ON BASE)					
	ENGLAND	ROBT. A.		B-13 MAY	1818	
				D-17 JAN	1899	
	ENGLAND	MARTHA J.		B-25 MAY	1830	
				D-17 MAR	1891	
	ENGLAND	JERUSHA		B-25 MAR	1863	"MISS"
				D-21 DEC	1906	
	JACKSON	MRS. M. E.		B-23 NOV	1836	
				D-30 JUN	1904	
	MANN,			B- (NOV 1897)		AGE 2 YRS 4 MONTHS
		HORACE CLIFFORD		D-20 MAR	1900	

Notes: _____

- CEMETERY SURVEY SHEET -
DEKALB County, GA

Cemetery FELLOWSHIP PRIMITIVE BAPTIST CHURCH Page 35 / 43

Surveyor TED BROOKE, CUMMING, GA Date 12/26/94

Note	- Name -			- Dates -		Other Information
	Last	First	Middle	dy	mo/year	
	TRIBBLE,	MARY	BENNETT	B-10	OCT 1867	WIFE OF JAMES
				D-14	DEC 1905	W, TRIBBLE "MOTHER"
	TRIBBLE,	JAMES	W,	B-14	MAR 1855	"FATHER"
				D-4	SEP 1929	
D	SMITH,	DELLA	T,	B-	1903	
				D-	1991	
D	SMITH,	ERNEST	H,	B-	1896	
				D-	1965	
	SMITH,	ERNEST	H,	B-	4 FEB 1896	GEORGIA SK2 US NAVY
				D-	16 JUN 1965	WORLD WARR I.
D	YOUNG,	DOLLY	L,	B-	27 NOV 1890	
				D-	11 MAR 1970	
D	YOUNG,	EMMA	T,	B-	20 OCT 1892	
				D-	11 MAY 1970	
	YOUNG,	MARY	LILLIAN	B-	10 JAN 1920	
				D-	15 JAN 1920	
D	HAZLERIGS,	SADIE	LEE	B-	14 MAR 1885	
				D-	-	
D	HAZLERIGS,	FRED	B, SR.	B-	1 NOV 1888	
				D-	25 JUN 1971	
				B-		
				D-		
	(THE FOLLOWING THOMAS			B-	PLAT EXTENDS OVER 3	
	ROWS, BUT IS SURVEYED TOGETHER HERE):			D-		
				B-		
				D-		

Notes: _____

Ted O. Brooke
 2055 Foster Drive
 Cumming, GA 30130

- CEMETERY SURVEY SHEET -
DEKALB County, GA

Cemetery FELLOWSHIP PRIMITIVE BAPTIST CHURCH Page 36 / 43

Surveyor TED BROOKE, CUMMING, GA Date 12/26/94

Note	Last	First	Middle	B	D	Other Information	
				dy	mo	year	
	THOMAS,	WILLIAM	LYLE JR.	B-18	JUL	1926	PFC US MARINE CORPS WORLD WAR II
	THOMAS,	GERTRUDE	M.	B-27	AUG	1906	
				D-15	MAY	1964	
	THOMAS,	WILLIAM	L. SR.	B-11	AUG	1905	
				D-1	JUL	1980	
	THOMAS,	ROBERT	LEE	B-21	MAY	1875	
				D-28	MAR	1957	
	THOMAS,	EUFALA	P.	B-21	MAY	1876	
				D-23	JAN	1964	
	THOMAS,	RUTH	MUSETTE	B-24	AUG	1903	
				D-29	OCT	1957	
	THOMAS,	INFANT	SON	B-			INFANT SON OF MR. & MRS. W. L. THOMAS
				D-29	JAN	1929	
	CORBITT,	BEULAH	ROBERTS	B-1	JAN	1897	
				D-12	JUL	1986	
	CORBITT,	HOMER		B-9	OCT	1892	
				D-20	JAN	1954	
D	TAYLOR,	GUS	A.	B-17	APR	1894	F = GUS
				D-25	NOV	1941	
D	SHAW,	EVELYN	TAYLOR	B-3	JUN	1901	F = MOTHER
				D-20	DEC	1992	
	CHEWNING,	DOUGLAS	E.	B-23	SEP	1944	CPL US MARINE CORPS VIETNAM
				D-16	NOV	1991	
				B-			
				D-			

Notes: _____

Ted O. Brooke
 2055 Foster Drive
 Cumming, GA 30130

- CEMETERY SURVEY SHEET -
DEKALB County, GA

Cemetery FELLOWSHIP PRIMITIVE BAPTIST CHURCH Page 37/43

Surveyor TED BROOKE, CUMMING, GA Date 12/26/94

Note	Last	First	Middle	Dates dy/mo/year	Other Information
D	COPELAND	SAMUEL A.		B- 20 JUL 1894 D- 14 JAN 1953	
D	COPELAND	ETHEL G.		B- 1 DEC 1896 D- -	
D	DICKENS	GROVER C.		B- 2 JUL 1893 D- 22 DEC 1966	F = FATHER
D	DICKENS	MAE		B- 8 OCT 1901 D- 9 JAN 1990	F = MOTHER
(END OF ROW 10, START OF ROW 11)					
(ROWS BECOME IRREGULAR AT THIS POINT)					
				D-	
	YOUNG	J. W.		B- 31 MAR 1857 D- 6 MAR 1935	
	YOUNG	LILLIAN		B- 17 JUN 1871 D- 9 JAN 1965	
	PRITCHETT	MAE YOUNG		B- 26 MAY 1894 D- 20 NOV 1922	
	MASSEY	ELIZABETH		B- 23 DEC 1941 D- 7 JAN 1942	DAU. OF MR. & MRS. C. H. MASSEY
				B-	
				D-	
				B-	
				D-	
				B-	
				D-	

Notes: _____

Ted O. Brooke
2055 Foster Drive
Cumming, GA 30130

- CEMETERY SURVEY SHEET -
DEKALB County, GA

Cemetery FELLOWSHIP PRIMITIVE BAPTIST CHURCH Page 38/43

Surveyor TED BROOKE, CUMMING, GA Date 12/26/94

Note	- Name -			- Dates -		Other Information
	Last	First	Middle	dy	mo/year	
	/ (FAMILY OF GEORGE R. AND			/ B-JANIE P. DICKENS)		-
	/ LARGE MARKER IN			/ D-PLOT)		
	/ SANDERS, PAUL L.			/ B-25 JUN 1909	/ D-29 DEC 1977	CPL US ARMY WORLD WAR II
	/ DECKER, DELLA D.			/ B-30 AUG 1905	/ D-29 OCT 1977	(HORIS A. WARD MKR; MAS. DELLA D. DECKER 1905-1977)
	/ DECKER, THOMAS J.			/ B-3 AUG 1907	/ D-17 DEC 1952	
	/ (DICKENS), JANIE P.			/ B-1 MAR 1876	/ D-10 FEB 1947	(MOTHER)
	/ (DICKENS), GEORGE R.			/ B-23 OCT 1873	/ D-7 JUL 1944	FATHER
/ (END OF ROW 11, START OF ROW 12)						
	/ TURNER, JESSE H.			/ B-18 DEC 1896	/ D-11 JAN 1981	
D	/ TURNER, JUDGE L.			/ B-6 APR 1849	/ D-9 OCT 1921	
D	/ TURNER, ELIZABETH M.			/ B-14 FEB 1855	/ D-28 OCT 1934	
	/ TURNER, LEWIS			/ B-7 JAN 1878	/ D-6 JUN 1901	F = "L.G.T."
	/ GOODMAN					
D	/ JACKSON, ZELMA N.			/ B-16 AUG 1905	/ D-17 FEB 1981	MARRIED JUNE 13, 1944
D	/ JACKSON, HAZEL M.			/ B-2 DEC 1913	/ D-2 APR 1977	

Notes: _____

Ted O. Brooke
 2055 Foster Drive
 Cumming, GA 30130

- CEMETERY SURVEY SHEET -
DEKALB County, GA

Cemetery FELLOWSHIP PRIMITIVE BAPTIST CHURCH Page 39 / 43

Surveyor TED BROOKE, CUMMING, GA Date 12/26/94

Note	Last	First	Middle	Dates	Other Information
				dy/mo/year	
U	(GRANITE)			B- D-	
U	(GRANITE)			B- D-	
D	BURNETT	WADE	H.	B-3 MAY 1888 D-26 JUN 1864	F = FATHER
D	BURNETT	OLLIE	C.	B-24 NOV 1893 D-7 JUL 1978	F = MOTHER
	BRITT	WILEY	T.	B-1 JUL 1866 D-22 AUG 1901	(MARR BROKEN)
	BURNETT	ANNIE	GRACE	B-6 APR 1931 D-12 JAN 1932	F = BABY
	(60-80' TO NEXT MARKERS)				
	YOUNGBLOOD	RUTH	S.	B-1 OCT 1906 D-18 APR 1964	
	SUMMERLIN	FRANCES	E.	B-16 DEC 1903 D-6 OCT 1966	"SUMMERLIN" ON SLAB
(END OF ROW 12, START OF ROW 13)					
U	5 VERTICAL MARBLE PIECES - NO INSCRIPTIONS				
D	DICKENS	JAS.	T.	B-12 JUN 1846 D-20 APR 1908	"FATHER AND MOTHER"
D	DICKENS	DELUSKY		B-20 MAY 1850 D-9 DEC 1915	WIFE OF JAS T. DICKENS

Notes: _____

Ted O. Brooke
 2055 Foster Drive
 Cumming, GA 30130

- CEMETERY SURVEY SHEET -
DEKALB County, GA

Cemetery FELLOWSHIP PRIMITIVE BAPTIST CHURCH Page 40 / 43

Surveyor TED BROOKE, CUMMING, GA Date 12/26/94

Ted O. Brooke
 2055 Foster Drive
 Cumming, GA 30130

Note	Last	First	Middle	- Name -	- Dates -	Other Information
					dy/mo/year	
		DICKENS,	VIVIAN		B-19 NOV 1925 D-19 NOV 1925	"BABY" F="V.O."
		DICKENS,	BENNIE		B-24 FEB 1940 D-27 FEB 1940	
D		DICKERSON,	THOS. W.		B-13 AUG 1848 D-14 SEP 1920	F= FATHER
D		DICKERSON,	NANCY A.		B-3 JUL 1845 D-25 SEP 1922	F= MOTHER
		MURPHY,	CHARLES		B- - D- -	"BABY CHARLES"
		MURPHY,	JACK		B-9 AUG 1927 D-4 AUG 1946	
		MURPHY,	DORIS		B-6 MAY 1932 D-10 DEC 1947	
D		MURPHY,	CHARLIE F.		B-16 FEB 1890 D-12 JAN 1977	F= FATHER
D		MURPHY,	ESTELLE		B-3 APR 1887 D-12 MAY 1977	F= MOTHER
		QUEEN,	LUCILE MURPHY		B-2 JUL 1917 D-1 NOV 1988	
		QUEEN,	JERRY		B-28 OCT 1941 D-23 JUL 1964	
		TANKERSLEY,	RANDY M.		B-14 NOV 1947 D-22 OCT 1989	
		PRICE,	HOMER L.		B-1906 D-1976	
		(END OF MAIN SECTION)				

Notes: _____

- CEMETERY SURVEY SHEET -
DEKALB County, GA

Cemetery FELLOWSHIP PRIMITIVE BAPTIST CHURCH Page 41 / 43

Surveyor TED BROOKE, CUMMING, GA Date 12/26/94

Note	- Name -			- Dates -		Other Information
	Last	First	Middle	dy	mo/year	
	(LYING IN WOODS 40 FEET WEST OF JACKSON MARKERS IN ROW 12)			B-		
				D-		
	STANLEY	MALISSA		B-	12 JUL 1850	
				D-	17 NOV 1903	
				B-		
				D-		
				B-		
				D-		
				B-		
				D-		
				B-		
				D-		
				B-		
				D-		
				B-		
				D-		

Ted O. Brooke
 2055 Foster Drive
 Cumming, GA 30130

Notes: _____

- CEMETERY SURVEY SHEET -
DEKALB County, GA

Cemetery FELLOWSHIP PRIMITIVE BAPTIST CHURCH Page 42 / 43

Surveyor TED BROOKE, CUMMING, GA Date 12/26/94

Ted O. Brooke
2055 Foster Drive
Cumming, GA 30130

Note	Last	First	Middle	B- dy	D- mo	Year	Other Information
------	------	-------	--------	----------	----------	------	-------------------

(FOLLOWING GRAVE MARKERS ARE IN "SOUTH" SECTION, SEPERATED FROM THE MAIN CEMETERY)

				B-			
				D-			

	FLURRY, J.	LELAND		B-	22	NOV 1913	
				D-	22	MAR 1988	

D	FLURRY, RICHARD D.			B-	4	SEP 1886	(MASONIC EMBLEM)
				D-	27	MAR 1953	

D	FLURRY, LULA E.			B-	2	AUG 1888	
				D-	29	MAY 1969	

	THROWER, PRISCILLA E.			B-	16	AUG 1947	
		GRESHAM		D-	24	APR 1954	

	THROWER, B. SUE			B-	10	AUG 1924	"BELOVED MOTHER & GRANDMOTHER"
				D-	2	JUN 1994	

	THROWER, ADAM W.			B-	27	MAR 1913	PFC US ARMY WORLD WAR II
				D-	16	MAY 1985	

	HAMLIN, WALTER B. JR.			B-	9	JUL 1941	
				D-	3	JUN 1972	

	HAMLIN, ELLA LUCILLE			B-	1	NOV 1904	
				D-	6	JUN 1979	

	HAMLIN, WALTER B.			B-	25	DEC 1898	PFC MED DET BASE HOSP 43 WORLD WAR I
				D-	16	MAR 1958	

D	CHEWNING, J. THOMAS			B-	1875		
				D-	1957		

D	CHEWNING, ELLA MAE D.			B-	1883		
				D-	1967		

Notes: _____

- CEMETERY SURVEY SHEET -
DEKALB County, GA

Cemetery FELLOWSHIP PRIMITIVE BAPTIST CHURCH Page 43 / 43

Surveyor TED BROOKE, CUMMING, GA Date 12/26/94

Note	- Name -			- Dates -		Other Information
	Last	First	Middle	dy	mo/year	
D	MAYO	JAMES	LEONARD	B-24	OCT 1907 / D-29 DEC 1973	F = J, L, M, (CHOALS A. WARD FUN. MKR)
D	MAYO	GLADICE	L.	B-13	JAN 1901 / D-18 FEB 1980	F = G, L, M.
	LINDSAY	PAUL	LEONARD	B-14	FEB 1912 / D-28 APR 1981	
	("LINDSAY" ON BASE OF 5' TALL OBELISK COLUMN)					
D	MAYO	JACQUENITA	LINDSAY	B-28	APR 1909 / D-	
D	MAYO	ROBERT	GRADY	B-17	AUG 1909 / D-30 JUN 1976	
	MAYO	ROBERT	G.	B-17	AUG 1909 / D-30 JUN 1976	LCOR US NAVY WORLD WARR
	LINDSAY	CARL	PHILIP	B-23	AUG 1916 / D-3 NOV 1991	
	("LINDSAY" PLOT MARKER)					
	LINDSAY	MAX	C.	B-1	DEC 1914 / D-29 MAY 1984	
	("LINDSAY" PLOT MARKER)					
	— END — (26 DEC 1994, JOB)					
				B-		
				D-		

Notes: _____

Ted O. Brooke
 2055 Foster Drive
 Cumming, GA 30130

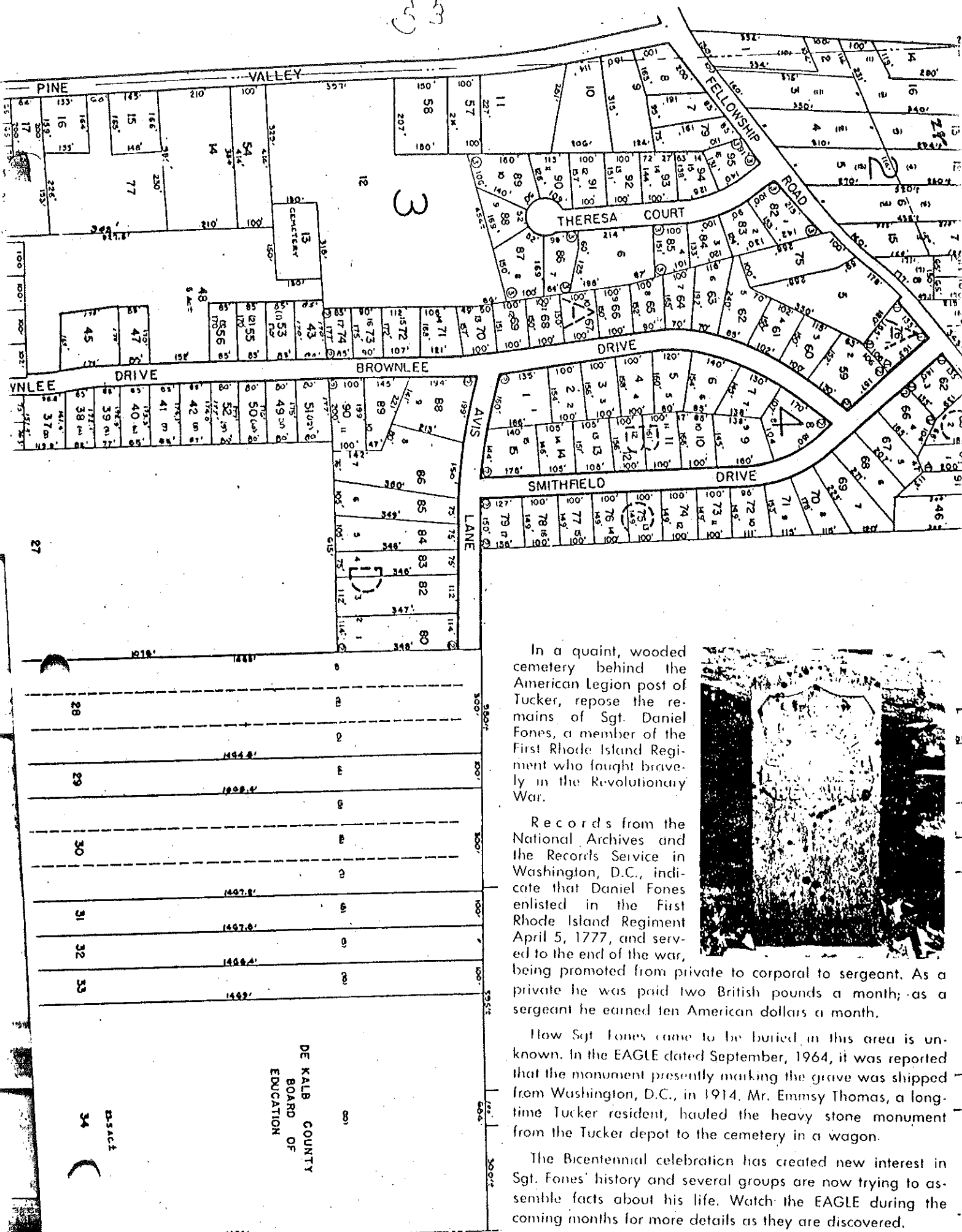

In a quaint, wooded cemetery behind the American Legion post of Tucker, repose the remains of Sgt. Daniel Fones, a member of the First Rhode Island Regiment who fought bravely in the Revolutionary War.

Records from the National Archives and the Records Service in Washington, D.C., indicate that Daniel Fones enlisted in the First Rhode Island Regiment April 5, 1777, and served to the end of the war, being promoted from private to corporal to sergeant. As a private he was paid two British pounds a month; as a sergeant he earned ten American dollars a month.

How Sgt. Fones came to be buried in this area is unknown. In the EAGLE dated September, 1964, it was reported that the monument presently marking the grave was shipped from Washington, D.C., in 1914. Mr. Emmsy Thomas, a long-time Tucker resident, hauled the heavy stone monument from the Tucker depot to the cemetery in a wagon.

The Bicentennial celebration has created new interest in Sgt. Fones' history and several groups are now trying to assemble facts about his life. Watch the EAGLE during the coming months for more details as they are discovered.



DE KALB COUNTY
BOARD OF
EDUCATION

DE KALB COUNTY
BOARD OF
EDUCATION

34

